

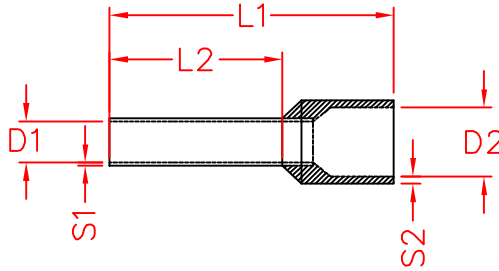

ET TYPE



ITEM NO.	DIMENSIONS							COLOR		
	mm ²	D1	D2	L1	L2	S1	S2	DIN	W	T
ET0.25-6	0.25	0.75 ^{+0.14} ₀	1.9±0.2	10±1.5	6±0.4	0.15±0.05	0.25±0.1		LIGHT BLUE	VIOLET
ET0.25-8				12±1.5	8±0.4					
ET0.34-6	0.34	0.8± ^{0.14} ₀	1.9±0.2	10±1.5	6±0.4	0.15±0.05	0.25±0.1		TURQ-UOSE	PINK
ET0.34-8				12±1.5	8±0.4					
ET0.5-6	0.5	1.0± ^{0.14} ₀	2.6±0.2	12±1.5	6±0.4	0.15±0.05	0.25±0.1	WHITE	ORANGE	WHITE
ET0.5-8				14±1.5	8±0.4					
ET0.5-10				16±1.5	10±0.4					
ET0.75-6	0.75	1.2± ^{0.14} ₀	2.8±0.2	12±1.5	6±0.4	0.15±0.05	0.25±0.1	GREY	WHITE	BLUE
ET0.75-8				14±1.5	8±0.4					
ET0.75-10				16±1.5	10±0.4					
ET0.75-12				18±1.5	12±0.4					
ET1.0-6	1.0	1.4± ^{0.14} ₀	3.0±0.2	12±1.5	6±0.4	0.15±0.05	0.25±0.1	RED	YELLOW	RED
ET1.0-8				14±1.5	8±0.4					
ET1.0-10				16±1.5	10±0.4					
ET1.0-12				18±1.5	12±0.4					
ET1.5-8	1.5	1.7± ^{0.25} ₀	3.5±0.2	14±1.5	8±0.4	0.15±0.05	0.25±0.1	BLACK	RED	BLACK
ET1.5-10				16±1.5	10±0.4					
ET1.5-12				18±1.5	12±0.4					
ET1.5-18				24±2.0	18±0.4					
ET2.5-8	2.5	2.2± ^{0.25} ₀	4.2±0.2	14±1.5	8±0.4	0.15±0.05	0.25±0.1	BLUE	BLUE	GREY
ET2.5-10				16±1.5	10±0.4					
ET2.5-12				18±1.5	12±0.6					
ET2.5-18				24±2.0	18±0.6					
ET4-10	4.0	2.8± ^{0.25} ₀	4.8±0.4	17±1.5	10±0.4	0.2±0.05	0.3±0.1	GREY	GREY	ORANGE
ET4-12				20±1.5	12±0.6					
ET4-18				26±2.0	18±0.6					
ET6-12	6.0	3.5± ^{0.3} ₀	6.3±0.4	20±1.5	12±0.6	0.2±0.05	0.3±0.1	YELLOW	BLACK	GREEN
ET6-18				26±2.0	18±0.6					
ET10-12	10.0	4.5± ^{0.3} ₀	7.6±0.4	22±2.0	12±0.6	0.2±0.05	0.4±0.15	RED	IVORY	BROWN
ET10-18				28±2.0	18±0.6					
ET16-12	16.0	5.8± ^{0.3} ₀	8.8±0.4	24±2.0	12±0.6	0.2±0.05	0.4±0.15	BLUE	GREEN	IVORY
ET16-18				28±2.0	18±0.6					
ET25-16	25.0	7.3± ^{0.4} ₀	11.2±0.4	28±2.0	16±0.6	0.2±0.05	0.4±0.15	YELLOW	BROWN	BLACK
ET25-18				30±2.0	18±0.6					
ET25-22				35±2.0	22±0.6					
ET35-12	35.0	8.3± ^{0.4} ₀	12.7±0.5	26±2.0	12±0.4	0.2±0.05	0.4±0.15	RDE	BEIGE	RDE
ET35-16				30±2.0	16±0.6					
ET35-18				32±2.0	18±0.6					
ET35-25				39±2.0	25±0.6					
ET50-20	50.0	10.3± ^{0.4} ₀	15.0±0.5	36±2.0	20±0.6	0.3±0.05	0.5±0.15	BLUE	OLIVE	BLUR
ET50-25				40±2.0	25±0.6					
ET70-21	70.0	13.5± ^{0.4} ₀	16.0±1.0	37±2.0	21±0.6	0.4±0.05	0.6±0.15	YELLOW		
ET95-25	95.0	14.7± ^{0.4} ₀	18.0±1.0	44±2.0	25±0.6	0.4±0.05	0.6±0.15	RDE		
ET120-27	120.0	16.7± ^{0.4} ₀	20.0±1.0	48±2.0	27±0.6	0.45±0.05	0.7±0.15	BLUE		
ET150-32	150.0	19.5± ^{0.4} ₀	23.0±1.0	58±2.0	32±0.6	0.5±0.05	1.0±0.15	YELLOW		

承認
KSS
107.11.01
邱平裕

審查

製圖
KSS
107.11.01
謝文通

設計

中文名		MATERIAL		ITEM NO.	
歐式端子		Insulation:NYLON 94V-2		ET TYPE	
SCALE		Terminal:COPPER		NAME	
mm		Plating:Tin plated		CORD END TERMINAL	
△ ()		TOLERANCE AS FIGURE		△ 11-01-2018	
使用機種				DATE REVISIONS K002	
				R.NO.	

Technical Data

Cord End Terminal

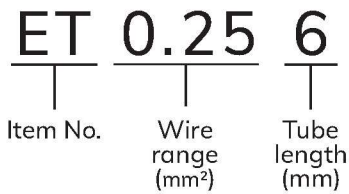

■ DIN德：DIN 顏色、W德：German 顏色、T法：French 顏色

■ 訂購顏色代號：

Black = **BK** Red = **RD** Orange = **OE** Yellow = **YW** Green = **GN** Blue = **BE**
 紫 = **VT** Grey = **GY** White = **WE** 褐 = **BN** Pink = **PK** Ivory = **IY**
 膚色 = **BG** Light Blue = **LE** 橄欖綠 = **OG** 土耳其綠 = **TE**

Item No.	Cord		
	DIN	W	T
ET0.25-6		Light Blue ○	紫 ●
ET0.25-8		Light Blue ○	紫 ●
ET0.34-6		土耳其綠 ○	Pink ●
ET0.34-8		土耳其綠 ○	Pink ●
ET0.5-6	White ○	Orange ●	White ○
ET0.5-8	White ○	Orange ●	White ○
ET0.5-10	White ○	Orange ●	White ○
ET0.75-6	Grey ○	White ○	Blue ●
ET0.75-8	Grey ○	White ○	Blue ●
ET0.75-10	Grey ○	White ○	Blue ●
ET0.75-12	Grey ○	White ○	Blue ●
ET1.0-6	Red ●	Yellow ●	Red ●
ET1.0-8	Red ●	Yellow ●	Red ●
ET1.0-10	Red ●	Yellow ●	Red ●
ET1.0-12	Red ●	Yellow ●	Red ●
ET1.5-8	Black ●	Red ●	Black ●
ET1.5-10	Black ●	Red ●	Black ●
ET1.5-12	Black ●	Red ●	Black ●
ET1.5-18	Black ●	Red ●	Black ●
ET2.5-8	Blue ●	Blue ●	Grey ○
ET2.5-10	Blue ●	Blue ●	Grey ○
ET2.5-12	Blue ●	Blue ●	Grey ○

Item No.	Cord		
	DIN	W	T
ET2.5-18	Blue ●	Blue ●	Grey ○
ET4-10	Grey ○	Grey ○	Orange ●
ET4-12	Grey ○	Grey ○	Orange ●
ET4-18	Grey ○	Grey ○	Orange ●
ET6-12	Yellow ●	Black ●	Green ●
ET6-18	Yellow ●	Black ●	Green ●
ET10-12	Red ●	Ivory ○	褐 ●
ET10-18	Red ●	Ivory ○	褐 ●
ET16-12	Blue ●	Green ●	Ivory ○
ET16-18	Blue ●	Green ●	Ivory ○
ET25-16	Yellow ●	褐 ●	Black ●
ET25-18	Yellow ●	褐 ●	Black ●
ET25-22	Yellow ●	褐 ●	Black ●
ET35-16	Red ●	膚色 ●	Red ●
ET35-18	Red ●	膚色 ●	Red ●
ET35-25	Red ●	膚色 ●	Red ●
ET50-20	Blue ●	橄欖綠 ●	Blue ●
ET50-25	Blue ●	橄欖綠 ●	Blue ●
ET70-21	Yellow ●		
ET95-25	Red ●		
ET120-27	Blue ●		
ET150-32	Yellow ●		

Twin Cord End Terminal

Item No.	Cord		
	DIN	W	T
EW0.5-8	White ○	Orange ●	White ○
EW0.75-8	Grey ○	White ○	Blue ●
EW0.75-10	Grey ○	White ○	Blue ●
EW1.0-8	Red ●	Yellow ●	Red ●
EW1.0-10	Red ●	Yellow ●	Red ●
EW1.5-8	Black ●	Red ●	Black ●
EW1.5-12	Black ●	Red ●	Black ●

Item No.	Cord		
	DIN	W	T
EW2.5-10	Blue ●	Blue ●	Grey ○
EW2.5-13	Blue ●	Blue ●	Grey ○
EW4-12	Grey ○	Grey ○	Orange ●
EW6-14	Yellow ●	Black ●	Green ●
EW10-14	Red ●	Ivory ○	褐 ●
EW16-14	Blue ●	Green ●	Ivory ○