

active

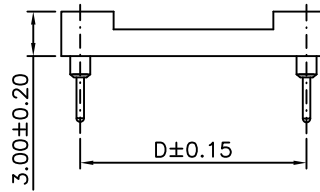

Specifications:

Current rating:1.0A AC/DC
 Voltage rating:100V AC/DC
 Contact resistance:15m ohm. max.
 Insulator resistance:5000M ohm. Min.
 Withstanding voltage:1000V AC for one minute
 Operating temperature range:-40°C to +105°C
 Material and Finish:
 Insulator:PBT (UL94V-0)
 Standard Color:Black
 Contact:Beryllium Copper(Becu) Gold Plated
 Sleeve Barrel:Copper Alloy Tin Plated

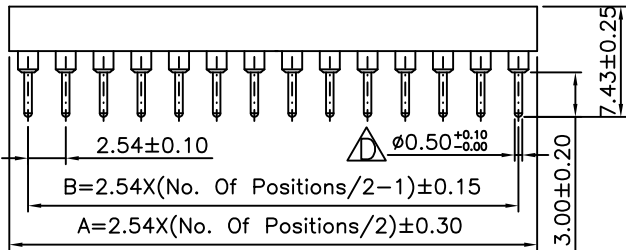
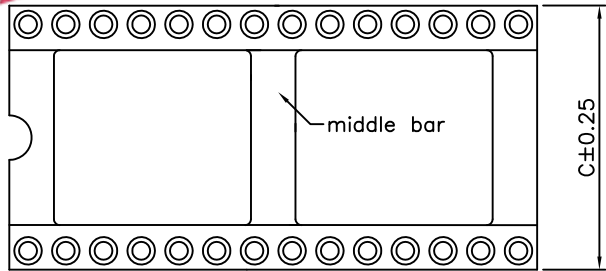
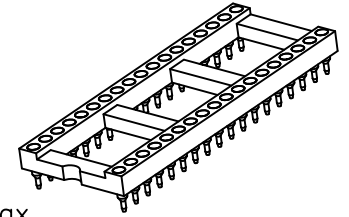

How To Order
 2227MC-XX-XX-XX

Standard With middle bar
 01:W/O middle bar
 03: Space:7.62mm
 06: Space:15.24mm
 No. Of Positions
 MC:Machine Pin

Note1: W/O middle bar(6~16P)
 With middle bar(18~64P)

Circuits	DIM.A	DIM.B	DIM.C	DIM.D	Space	Circuits	DIM.A	DIM.B	DIM.C	DIM.D	Space
6	7.62	5.08	10.16	7.62	03	24	30.48	27.94	17.78	15.24	06
8	10.16	7.62	10.16	7.62		28	35.56	33.02	17.78	15.24	
14	17.78	15.24	10.16	7.62		32	40.64	38.10	17.78	15.24	
16	20.32	17.78	10.16	7.62		40	50.80	48.26	17.78	15.24	
18	22.86	20.32	10.16	7.62		42	53.34	50.80	17.78	15.24	
20	25.40	22.86	10.16	7.62		48	60.96	58.42	17.78	15.24	
24	30.48	27.94	10.16	7.62							
28	35.56	33.02	10.16	7.62							

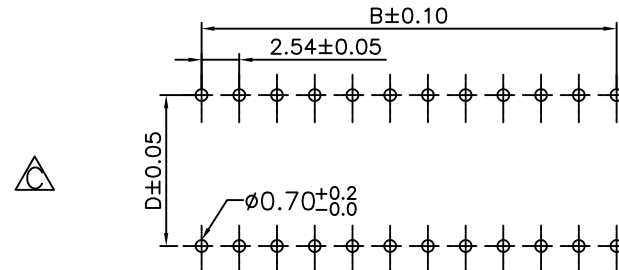

PCB Layout

RoHS Compliant

F			
E			
D	17-May-2016	ECN-TW1605012	Blake Huang
C	08-SEP-2009	ECN-TW090901	Allen
B	05-SEP-2008	ECN-TW0800904	Allen
A	31-JUL-2008		Allen
REV	DATE	FILE	BY

DRAWN: Allen
 CHECKED: Jerry Chen
 APPROVAL: Mike Wu

GENERAL TOLERANCE:
 .X=±0.20
 .XX=±0.15
 UNIT: MM
 SCALE: 1:1
 SHEET: 1 / 1
 PROJECTION:



Neltron Industrial Co., Ltd.

DESCRIPTION: 2.54mm IC Socket Machine Pin
 PART NO: 2227MC-XX-XX-XX

SIZE
A4