

1

2

3

4

5

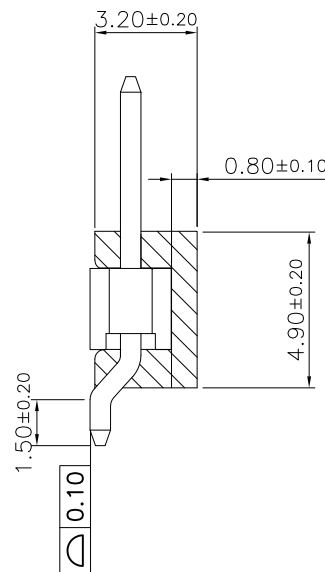
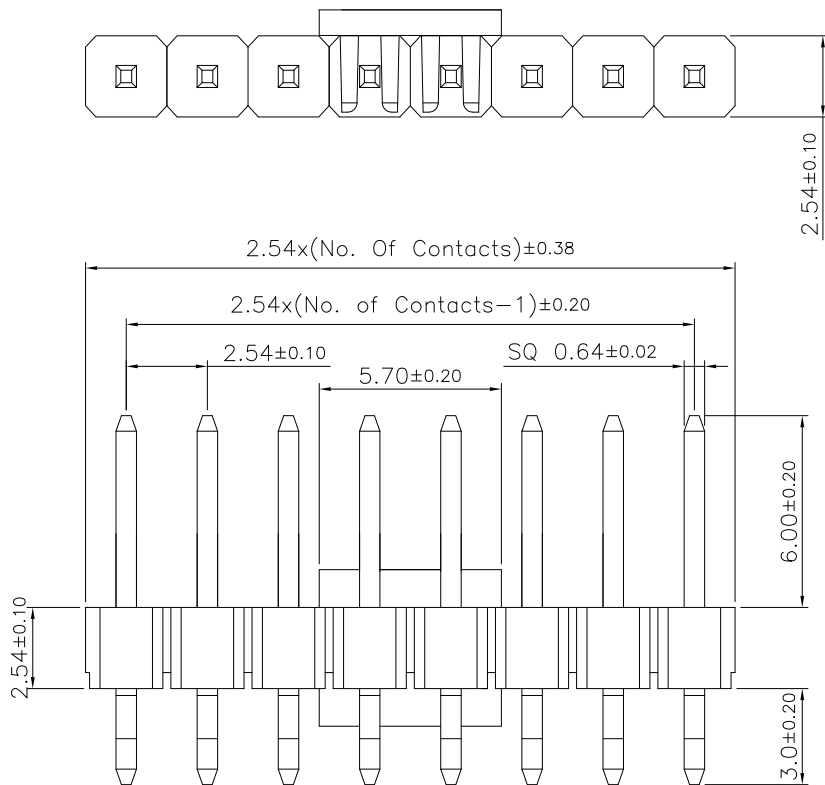

Specifications:

Current rating:3A AC/DC

Voltage Rating:250V AC/DC

Contact Resistance:20m ohm Max

Insulation Resistance:1000M ohm Min

Withstanding Voltage:500V AC For one Minute

Operating Temperature Range:-40°C To +105°C

Materials:

Insulator:High Temp.Plastic(Nylon 6T UL94V-0)

Insulator Color:Black

Contact:Brass

Plating:Gold Plated,Tin Plated,Selective Gold

How To Order

2211R-XXX-SM-BK-6030A-CR

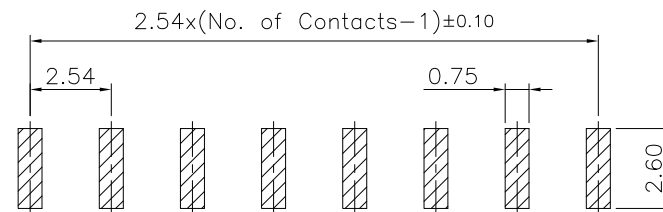
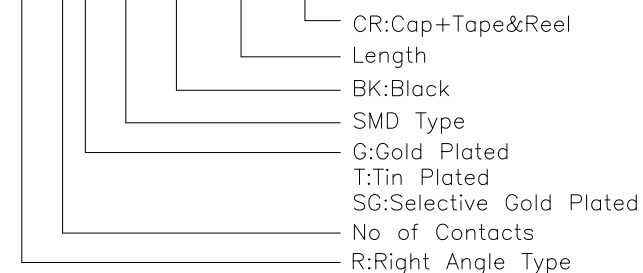

P.C.B Layout

RoHS Compliant

F				DRAWN: Lisy Liu	GENERAL TOLERANCE: .X=±0.20 .XX=±0.15	Neltron Industrial Co., Ltd.	DESCRIPTION: 2.54mm Pin Header Single Row Right Angle &SMD Type	SIZE
E								
D				CHECKED: Jerry Chen	UNIT: MM	PART NO: 2211R-XXX-SM-BK-6030A-CR	A4	
C					SCALE:			
B				APPROVAL: Rory Chen	SHEET: 1/1			
A	18-SEP-2020		Lisy		PROJECTION:			
REV	DATE	FILE	BY					